

Fuel Vapor Tube Assembly

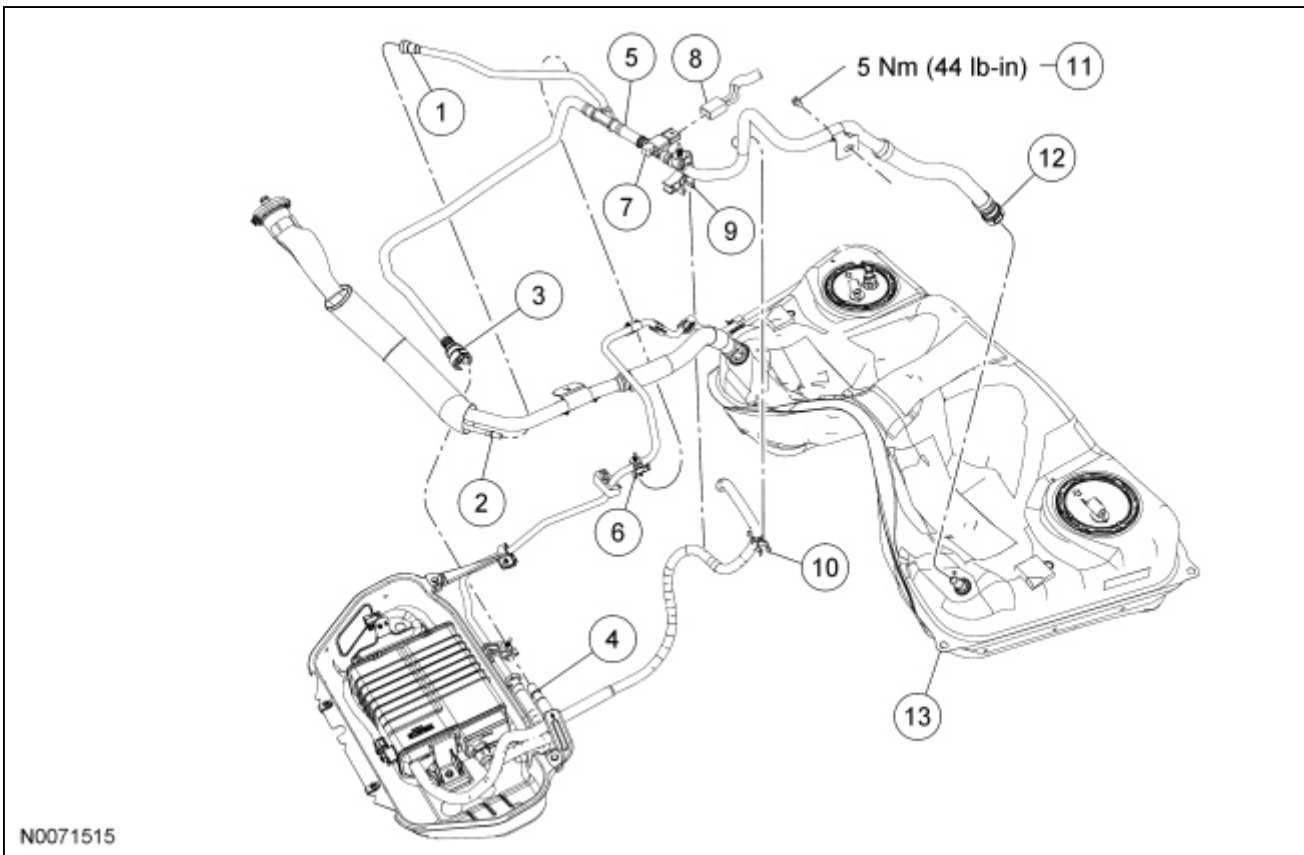

Item	Part Number	Description
1	—	Fuel vapor tube assembly-to-fuel tank filler pipe recirculation tube spring lock coupling (part of 9E325)
2	—	Fuel tank filler pipe recirculation tube (part of 9034)
3	—	Fuel vapor tube assembly-to-Evaporative Emission (EVAP) canister tank tube quick connect coupling (part of 9E325)
4	—	EVAP canister assembly tank tube (part of 9E857)
5	9E325	Fuel vapor tube assembly
6	—	Fuel tube bundle assembly retainer clip (4 required) (part of 9J279)
7	9C052	Fuel Tank Pressure (FTP) sensor (part of 9E325)
8	14A464	FTP sensor electrical connector
9	—	Fuel vapor tube assembly retainer clip (part of 9E325)
10	—	EVAP canister assembly vapor tube retainer clip (part of 9E857)
11	W504081S	Fuel vapor tube assembly bracket bolt
12	—	Fuel vapor tube assembly-to-fuel tank quick connect coupling (part of 9E325)
13	9002	Fuel tank

Removal and Installation



WARNING: Do not smoke, carry lighted tobacco or have an open flame of any type when working on or near any fuel-related component. Highly flammable mixtures are always present and may be ignited. Failure to follow these instructions may result in serious personal injury.



WARNING: Do not carry personal electronic devices such as cell phones, pagers or audio equipment of any type when working on or near any fuel-related component. Highly flammable mixtures are always present and may be ignited. Failure to follow these instructions may result in serious personal injury.



WARNING: Always disconnect the battery ground cable at the battery when working on an evaporative emission (EVAP) system or fuel-related component. Highly flammable mixtures are always present and may be ignited. Failure to follow these instructions may result in serious personal injury.

1. With the vehicle in NEUTRAL, position it on a hoist. For additional information, refer to [Section 100-02](#).
 2. Disconnect the battery ground cable. For additional information, refer to [Section 414-01](#).
 3. Disconnect the Fuel Tank Pressure (FTP) sensor electrical connector.
 4. Disconnect the fuel vapor tube assembly-to-fuel tank quick connect coupling. For additional information, refer to [Section 310-00](#).
 5. Disconnect the fuel vapor tube assembly-to-Evaporative Emission (EVAP) canister tank tube quick connect coupling. For additional information, refer to [Section 310-00](#).
 6. Disconnect the fuel vapor tube assembly-to-fuel tank filler pipe recirculation tube quick connect coupling. For additional information, refer to [Section 310-00](#).
 7. Remove the fuel vapor tube assembly bracket bolt.
 - To install, tighten to 5 Nm (44 lb-in).
 8. Release the fuel vapor tube assembly retainer clip.
 9. Release the [EVAP](#) canister assembly vapor tube retainer clip.
 10. Release the 4 fuel tube bundle assembly retainer clips.
 11. Remove the fuel vapor tube assembly.
 12. To install, reverse the removal procedure.
 - Carry out the Evaporative Emission System Leak Test. For additional information, refer to [Evaporative Emission System Leak Test](#) in this section.
-

